



+44 (0) 1706 649217



+44 (0) 1706 655512



www.dunphy.co.uk

DATA SHEET

Model: TDO5

Revision Date: October 2004

Output: 160 – 1000 kW

Revision Number: DS.TD05.01



- ◆ Full electric fuel changeover system, switch selectable or remote control
- ◆ Separately controlled oil pump and motor
- ◆ Gas entry to top or bottom
- ◆ Two stage modulating or fully modulating on gas
- ◆ High/Low control on Oil
- ◆ Biogas, town gas and LPG options available
- ◆ All models approved to current British and European Standards.
- ◆ All models have been independently tested to the European Standard EN676 : 1997 'Automatic forced draught burners for gaseous fuels'.
- ◆ Ambient operating temperature 50°C max.
- ◆ All burners in the T.O. range are of the fan assisted, nozzle mix type and operation is fully automatic expanding flame start.

- ◆ **Natural Gas** - Minimum gas pressure of 25mb required at burner inlet.
 - ◆ **L.P.G.**
 - ◆ **Town Gas**
 - ◆ **Biogas**
- } Technical details available on request from Dunphy sales dept.



Certificate No. FM 24868
BS EN ISO 9001 : 2000

BURNER DIMENSIONS

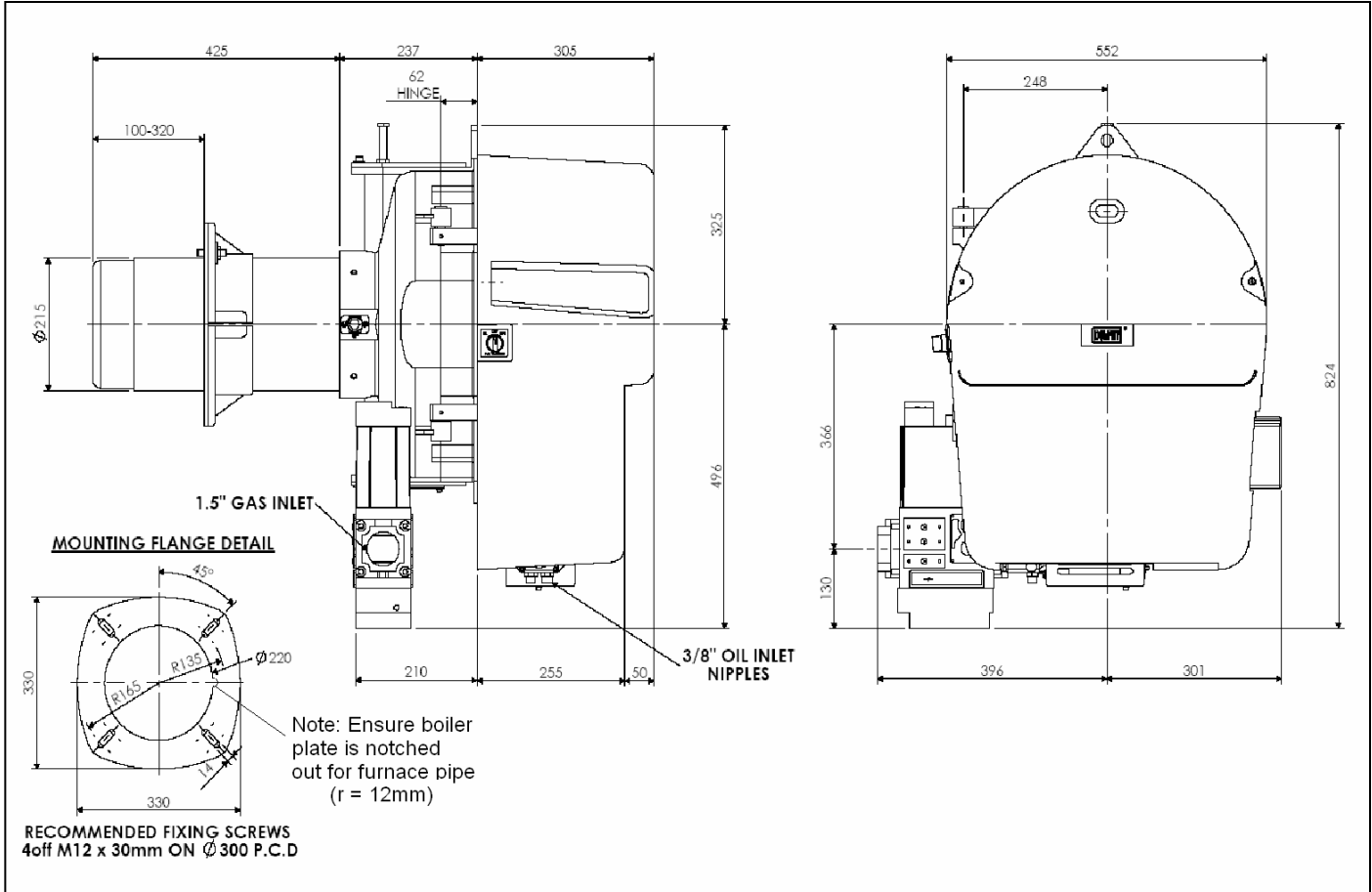

** The burner gas train may be positioned as shown or rotated to the left or right as required.

- ◆ All dimensions in mm unless otherwise stated.
- ◆ Please check the issue number to ensure validity.

BURNER RATING GRAPH

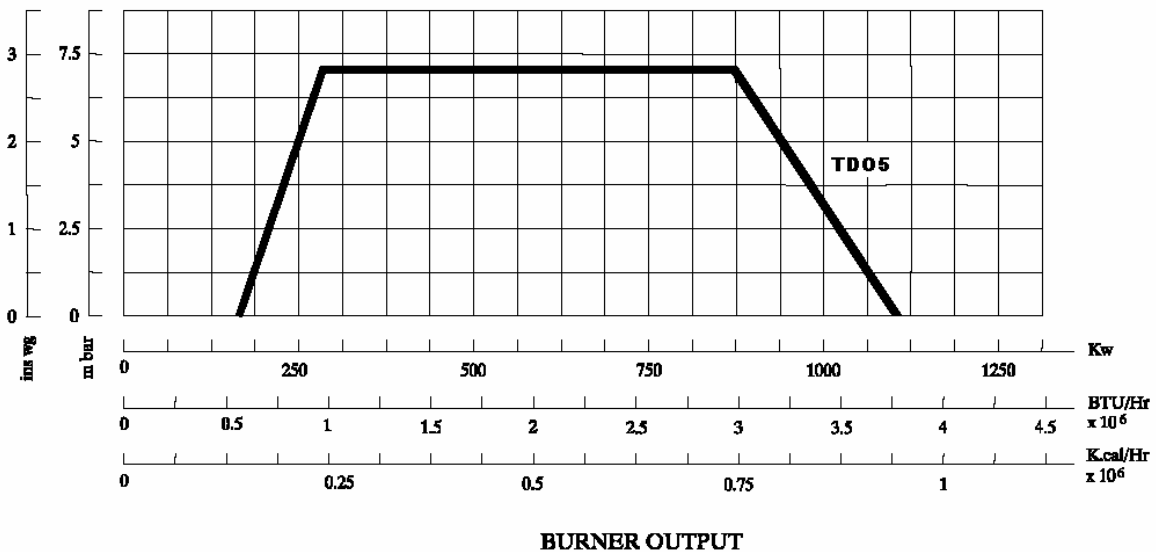

SPECIFICATION DATA

BURNER MODEL	Firing Rate kW		Burner Control	FCAD*	Control Input Type	GAS INLET 'R'	Min/Max Gas Pressure mbar	m³/Hour *(1)	Weight kg *(2)		
	MIN	MAX							A	B	C
TDO5.100 HL/HL	160	1000	High/Low Gas High/Low Oil	Yes	High / Low Stat	2" BSP	25 / 100	106	68	88	27
TDO5.100 MP/HL	160	1000	Modulating Gas High/Low Oil	Yes	3 wire up / down	2" BSP	25 / 100	106	68	88	27

BURNER MODEL	Burner Controls			Fan Motor Details						Oil Pump Details		
	Voltage	Hz	Ph	Voltage	Hz	Ph	Motor Watts	Running Current (A)	Starting Current (A)	Voltage	Ph	Motor Watts
TDO5.100 HL/HL	230V	50	1	415V	50	3	1100	2.3	11	230V	1	550
TDO5.100 MP/HL	230V	50	1	415V	50	3	1100	2.3	11	230V	1	550

*FCAD – Fully Closing Air Damper *(1) – Based on Nat. Gas C.U. 10.4kW/m *(2) – A – Burner Without valve, B- Burner with valve, C – Packaging weight

FEATURES



Gas Entry from top

- High efficiency
- Low Noise operation
- Integrated low gas pressure protection switch
- Adjustable flange for different furnace projections
- All gas valves factory prepared ready for immediate and simple connection to burner.



Gas Entry from bottom

- Acoustic lined cover as standard
- Full electric changeover for fuel selection
- Separate air damper setting for each fuel type
- Separate fuel pump and motor set eliminates wear and tear when operating on gas
- Volt Free contacts available on request



Dunphy Combustion Ltd. have a policy of continuous development and reserve the right to change specifications without prior notice